



Republic of the Philippines
Department of Education
Region VII – CENTRAL VISAYAS
SCHOOLS DIVISION OF BOHOL

Office of the Schools Division
Superintendent

October 10, 2022

Division Memorandum
No. **0667**, s. 2022

**Downloading of Funds intended for the Procurement of Materials, Supplies,
and Labor for the Construction of DepEd Temporary Learning Spaces
(TLS) in Schools Affected by Typhoon “ODETTE”**

ASDS, Chief of CID & SGOD
Concerned Public Schools District Supervisors/OIC PSDS
Concerned Public Elementary and Secondary School Principals/Head
District Finance Personnel
All Other Concerned

1. Attached is Memorandum OUGFO No. 2022-04-029 entitled “Guidelines on the Utilization, Documentation and Reporting of Funds Downloaded for the Procurement of Materials, Supplies, and Labor for the Construction of DepEd Temporary Learning Spaces (TLS) in Schools Affected by Typhoon “ODETTE” for the information and guidance of all concerned.
2. Funds intended for the Procurement of Materials, Supplies, and Labor for the Construction of DepEd Temporary Learning Spaces (TLS) in Schools Affected by Typhoon “ODETTE” will be downloaded to all recipient schools. All recipient schools on this support fund are directed to follow the Implementing Guidelines, documentation and reporting set on the attached Memorandum. Refer to **Annex A** for the list of schools entitled to be downloaded for the said funds.
3. Judicious utilization of the fund is expected. Misuse and /or mismanagement of these funds for the purpose other than those authorized in the provided guidelines is strictly prohibited.
4. Immediate dissemination of this Memorandum is highly directed.

BIANITO A. DAGATAN EdD, CESO V
Schools Division Superintendent 



0050 Lino Chatto Drive Barangay Cogon, Tagbilaran City, Bohol
Tel Nos.: (038) 412-4938; (038) 411-2544 (038) 501-7550
Telefax: (038) 501-7550 email add: deped.bohol@deped.gov.ph

**Behold...
BOHOL**



Republic of the Philippines
Department of Education
OFFICE OF THE UNDERSECRETARY
GOVERNANCE AND FIELD OPERATIONS

OUGFO No. 2022-04- 029
MEMORANDUM

TO : **Regional Directors**
(Caraga, Regions IV-B, VI, VII, and VIII)

Schools Division Superintendents
(Dinagat Island, Siargao City, Surigao del Norte, Palawan, Guimaras, Kabankalan City, Negros Occidental, Sipalay City, Bohol, Cebu City, Cebu, Naga City, Negros Oriental, Talisay City, Toledo City, Maasin, And Southern Leyte)

FROM : 
ATTY. REVSEE A. ESCOBEDO
Undersecretary for Governance and Field Operations

SUBJECT : **Guidelines on the Utilization, Documentation, and Reporting of Funds Downloaded for the Procurement of Materials, Supplies, and Labor for the Construction of DepEd Temporary Learning Spaces (TLS) in Schools Affected by Typhoon Odette**

DATE : 18 August 2022

Typhoon Odette has brought massive impacts to the education sector. Based on the reports submitted to the Disaster Risk Reduction and Management Service (DRRMS), Regions IV-B, VI, VII, VIII and CARAGA incurred damages in their schools and DepEd offices.

To support the response operations of the affected regions and divisions, P74.88 million from the FY 2022 GAAAO - Minimum Health Standard of DepEd Central Office shall be downloaded for the immediate provision of necessary response interventions enumerated in the attachments of this memorandum.

Attached herewith is the *Implementing Guidelines on the Utilization, Documentation, and Reporting of Funds Downloaded for the Procurement of Materials, Supplies, and Labor for the Construction of DepEd Temporary Learning Spaces (TLS) in Schools Affected by Typhoon Odette*.

For future correspondence on the above mentioned subject, please contact DRRMS via drmo@deped.gov.ph or at telephone no. (02) 8637-4933.

For information and compliance.

Implementing Guidelines on the Utilization, Documentation, and Reporting of Funds Downloaded for the Procurement of Materials, Supplies, and Labor for the Construction of DepEd Temporary Learning Spaces (TLS) in Schools Affected by Typhoon Odette

I. Pre-Procurement

1. Modification of DepEd TLS Design

- a. **Annex B** shows the standard DepEd TLS design with the list of materials needed for construction. In the absence of standard materials, Divisions may proceed with procurement of alternative materials available in the locality, provided that (a) changes in materials, design and specifications are in accordance with standards of a safe learning temporary facility; and (b) the Disaster Risk Reduction and Management Service (DRRMS) and Education Facilities Division (EFD) are informed of the changes.
- b. Any changes in materials, design and specifications should be prepared by the Division or Regional Engineer and approved by the Division Superintendent. Any modification should observe safety and functionality standards intended for DepEd TLS, which comprises, but are not limited to, the following:
 - i. DepEd TLS should last up to a period of at least six months.
 - ii. The size of DepEd TLS should follow the standard 7.2 X 8.4 square-meter design as indicated in Annex B (Standard DepEd TLS Design).
 - iii. DepEd TLS should have proper ventilation and lighting to make learning conducive.
 - iv. There should be walls around every unit of DepEd TLS, ensuring protection and minimizing distraction from surroundings.
 - v. The location of DepEd TLS should be in a safe area within the school premises.
- c. The labor cost of construction of DepEd TLS may be minimized by mobilizing the local government unit (LGU), Parents-Teachers Association (PTA), Armed Forces of the Philippines (AFP), Department of Social Welfare and Development (DSWD) (Cash for Work Program), and/or other available stakeholders and programs in the locality.
- d. The total cost per unit of the modified DepEd TLS should not exceed P180,000.00.
- e. All changes in DepEd TLS materials, design and specifications should be reported by Divisions immediately up until two weeks after the receipt of Sub-Allotment Release Order (SUB-ARO) to the Office of the

Undersecretary for Governance and Field Operations (OUGFO), with copies sent to the DRRMS and EFD. The following documents shall be submitted:

- i. Written narrative on the justification for such changes signed by the Superintendent;
- ii. Modified DepEd TLS design with corresponding costs duly prepared by the Engineer, and approved by the Superintendent; and
- iii. Accomplished Implementation Plan (Section A) of the TLS Monitoring Template attached as **Annex C**.

2. Realignment requests

- a. In cases where there are changes in TLS needs and interventions, Divisions may request for realignment of funds for DepEd TLS, provided that:
 - i. The funds requested to be realigned shall be used for the purpose of procurement of supplies, materials and labor for the construction of DepEd TLS for another school/s;
 - ii. The identified new recipient school/s by the Division has/have not been allocated with DepEd TLS by the DRRMS and has/have a shortage of classrooms due to damages; and
 - iii. The original school/s with DepEd TLS allocation confirm/s that there is/are no need for DepEd TLS in their school/s;
- b. The request for realignment of DepEd TLS shall consist of the following:
 - i. Narrative stating the changes in TLS needs and interventions and necessitating realignment of DepEd TLS from one school to another, to be duly signed by the Superintendent;
 - ii. Attached document from original school/s with allocated DepEd TLS stating that the school/s no longer need DepEd TLS signed by the School Head/s; and
 - iii. Vetted Rapid Assessment of Damage Report (RADaR) of the identified new school/s to receive DepEd TLS. The RADaR should include the number of damaged classrooms and total TLS needed;
- c. The required documents for realignment request shall be sent to DRRMS through OUGFO for review. The requested new list of schools, which meets the criteria set by the DRRMS, shall be endorsed to the Office of Undersecretary for Finance (OUF) for final approval.
- d. Realignment requests should be done within one (1) month after the sub-ARO has been downloaded to the Divisions concerned.

II. Procurement

1. The funds can only be utilized for the procurement of materials, supplies and labor for the construction of DepEd TLS. The Divisions can proceed with procurement of materials, supplies and labor for DepEd TLS short of award while waiting for the issuance of sub-ARO.
2. Procurement of supplies, materials and labor should be in accordance with existing procurement procedures. Various appropriate methods of procurement may be utilized to fast-track the completion.
3. All progress on procurement should be reported using the TLS Monitoring Template two (2) or four (4) weeks after the receipt of sub-ARO or earlier to the DRRMS.

III. Construction

1. All actual DepEd TLS should follow the standard design or the modified design submitted by Divisions. In addition to the abovementioned standards for DepEd TLS, the Division should ensure the safety of the location within the school premises where DepEd TLS will be constructed.
2. All progress on construction should be reported to the DRRMS using the TLS Monitoring Template four (4) or six (6) weeks after the receipt of sub-ARO or earlier.

IV. Monitoring

1. For the purpose of documentation and monitoring, recipient Divisions are required to do the following:
 - a. Consolidate and/or take photos of schools before and after TLS construction;
 - b. Archive copies of procurement documents and liquidation reports;
 - c. Provide a brief summary on gaps and issues during and after the implementation of TLS; response to the mentioned gaps and issues; and best practices, if any;
 - d. Accomplish the TLS Monitoring Template attached as Annex C; and
 - e. Submit photos, brief summary reports and accomplished TLS Monitoring template to the DRRMS.

2. All division DRRM Coordinators should ensure submission of the TLS Monitoring Template in three batches.

The first, second and third update on TLS Monitoring should be submitted on the second, fourth and sixth week after receipt of approved TLS allocation.

The first submission should include complete information on Implementation Plan (Section A), while the second and third submission should include remaining necessary information in the template.

The last submission on the sixth week after receipt of approved TLS allocation should include other pertinent documents and photos indicated in this Memorandum.

3. Likewise, the Division DRRM Coordinators are expected to coordinate with various offices such as the School Governance and Operations Division (SGOD), the Bids and Awards Committee (BAC) Secretariat and Division Finance Office to ensure timely submission and accuracy of the reports.
4. All Regional DRRM Coordinators are required to monitor the progress of TLS procurement and construction by ensuring that all Divisions submit the necessary documents on time, and that all submissions from Divisions are complete and accurate.
5. Reports should be submitted via email to drmo@deped.gov.ph and the Regional Offices. Any issues and concerns regarding procurement and construction of TLS should be reported to DepEd DRRMS immediately. For further clarifications please contact DRRMS at drmo@deped.gov.ph.

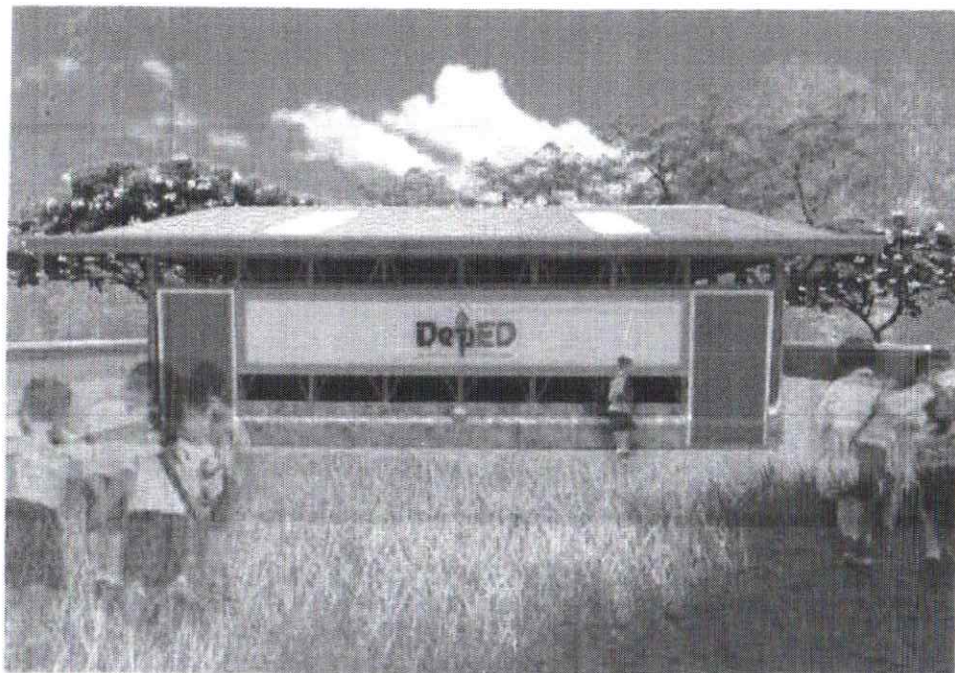

PROPOSED TEMPORARY LEARNING SPACE
EXTERIOR PERSPECTIVE 1

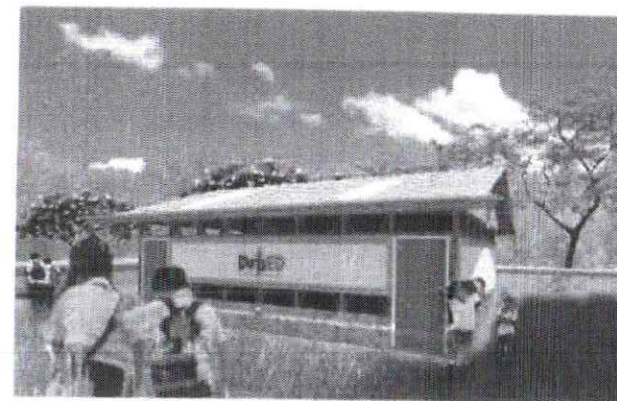

PROPOSED TEMPORARY LEARNING SPACE
EXTERIOR PERSPECTIVE 2



PROPOSED TEMPORARY LEARNING SPACE
INTERIOR PERSPECTIVE 2



PROPOSED TEMPORARY LEARNING SPACE
INTERIOR PERSPECTIVE 1

	PREPARED BY:  MARK ANTHONY LOPEZ, LCE 5 SENIOR EDUCATION CLERK III DIVISION OFFICE FOR RESEARCH AND MANAGEMENT SERVICE	CHECKED BY:  RODERICK B. PONCE, EdD DIVISION OFFICE FOR RESEARCH AND MANAGEMENT SERVICE	RECOMMENDING APPROVAL:  ENGR. ARMAND R. NACUA DIVISION OFFICE FOR RESEARCH AND MANAGEMENT SERVICE	APPROVED BY:  DEPARTMENT OF EDUCATION DIVISION OFFICE FOR RESEARCH AND MANAGEMENT SERVICE	PROJECT TITLE: PROPOSED TEMPORARY LEARNING SPACE LOCATION:	OWNER: DEPARTMENT OF EDUCATION DepEd ADDRESS: REPUBLIC AVENUE, PANGSIT, NOR	REMARKS: EXTERIOR PERSPECTIVE 1 EXTERIOR PERSPECTIVE 2 INTERIOR PERSPECTIVE 1 INTERIOR PERSPECTIVE 2	DRAWING NO.: 2024-01-01 PREPARED BY: MARK ANTHONY LOPEZ CHECKED BY: RODERICK B. PONCE APPROVED BY: ENGR. ARMAND R. NACUA
--	---	---	---	--	---	--	--	---

NOTE: THIS DRAWING, AS AN INSTRUMENT OF SERVICE IS THE PROPERTY OF PHYSICAL PROCEEDS IN DIVISION AND AS SUCH SHALL NOT BE REPRODUCED OR COPIED A PART OR IN WHOLE WITHOUT ALL INSTRUCTIONS ARE TO BE OBSERVED UNDER NO CIRCUMSTANCES IN LAW.

Annex B - Standard DepEd TLS Design

SCHEDULE OF WOOD COMPONENTS	
COMPONENT	SPECIFICATIONS
POST	100mmx100mm COCO LUMBER
BEAM GIRDER	50mmx75mm COCO LUMBER
RAFTER TOP CHORD	50mmx75mm COCO LUMBER
RAFTER RIDGE BOARD	50mmx100mm COCO LUMBER
RAFTER COLLAR TIE	50mmx75mm COCO LUMBER
PURLINS	50mmx50mm COCO LUMBER
DIAGONAL WALL STUD	50mmx50mm COCO LUMBER

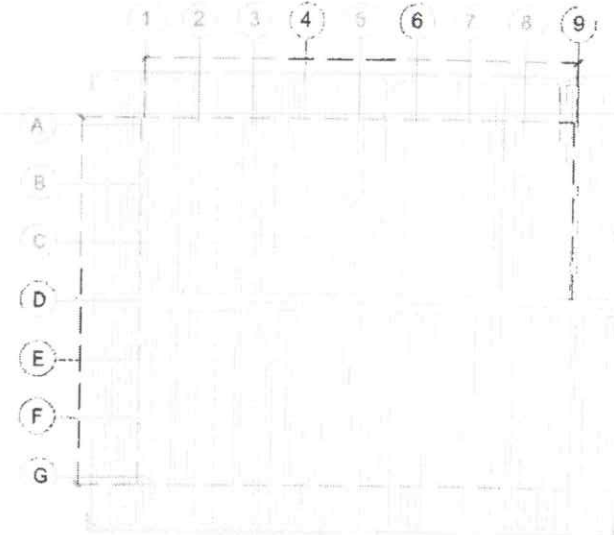
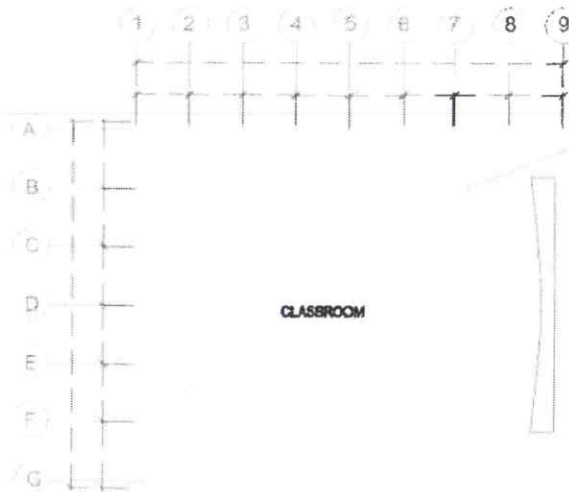

	DESIGNED BY: 	CHECKED BY: 	ENGINEER'S APPROVAL: 	APPROVED BY: 	PROJECT TITLE: PROPOSED TEMPORARY LEARNING SPACE	CLIENT: DEPARTMENT OF EDUCATION DepEd	COMMENTS: ROOF PLAN FLOOR PLAN	SHEET NO. 1/1 TOTAL SHEETS: 1
	DESIGNED BY: ARCE, WILFREDO L. C. C. C. DESIGNED FOR: DEPARTMENT OF EDUCATION	CHECKED BY: ARCE, WILFREDO L. C. C. C. CHECKED FOR: DEPARTMENT OF EDUCATION	ENGINEER'S APPROVAL: ENGR. ARCE, WILFREDO L. C. C. C. ENGINEER FOR: DEPARTMENT OF EDUCATION	APPROVED BY: ARCE, WILFREDO L. C. C. C. APPROVED FOR: DEPARTMENT OF EDUCATION	PROJECT TITLE: PROPOSED TEMPORARY LEARNING SPACE	CLIENT: DEPARTMENT OF EDUCATION DepEd	COMMENTS: ROOF PLAN FLOOR PLAN	SHEET NO. 1/1 TOTAL SHEETS: 1

THIS DRAWING IS AN INSTRUMENT OF SERVICE OF THE PROPERTY OF DEPARTMENT OF EDUCATION. IT IS TO BE USED ONLY FOR THE PROJECT AND NOT TO BE REPRODUCED OR COPIED IN ANY MANNER WITHOUT THE WRITTEN PERMISSION OF THE DEPARTMENT OF EDUCATION.

Annex B - Standard DepEd TLS Design

SCHEDULE OF WOOD COMPONENTS	
COMPONENT	SPECIFICATIONS
POST	100mmx100mm COCO LUMBER
BEAM GIRDER	50mmx75mm COCO LUMBER
RAFTER TOP CHORD	50mmx75mm COCO LUMBER
RAFTER RIDGE BOARD	50mmx100mm COCO LUMBER
RAFTER COLLAR TIE	50mmx75mm COCO LUMBER
PURLINS	50mmx50mm COCO LUMBER
DIAGONAL WALL STUD	50mmx50mm COCO LUMBER

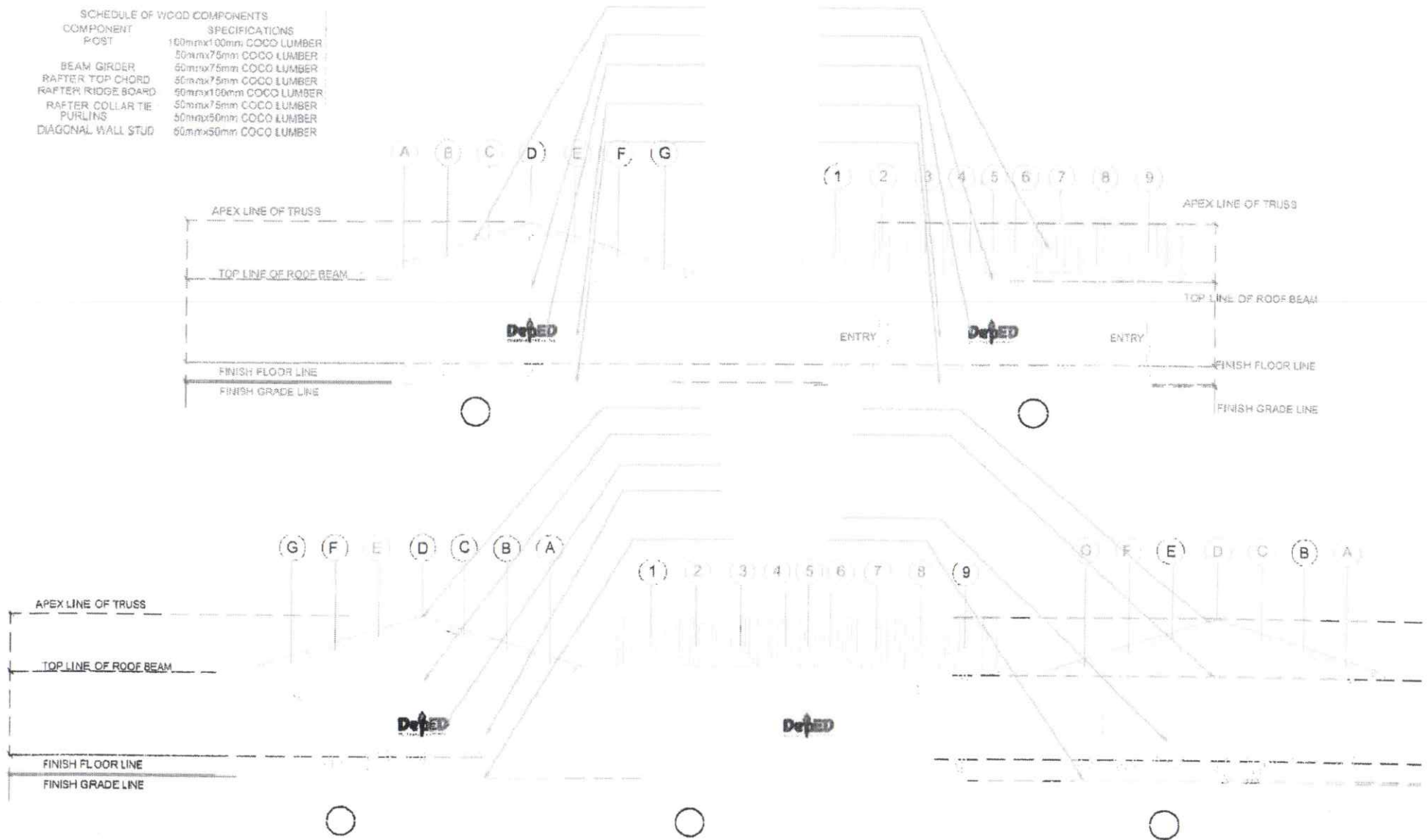

<div><div>DepED</div><div>Department of Education</div><div>Division Office - Marikina City</div></div>	DESIGNED BY: <div> MARICEL C. CELIS DESIGN ENGINEER, REGISTERED DIVISION OFFICE - MARIKINA CITY</div>	CHECKED BY: <div> MARICEL C. CELIS CHECKER DIVISION OFFICE - MARIKINA CITY</div>	RECOMMENDING APPROVAL: <div> MARICEL C. CELIS RECOMMENDING APPROVAL DIVISION OFFICE - MARIKINA CITY</div>	APPROVED BY: <div> MARICEL C. CELIS APPROVED BY DIVISION OFFICE - MARIKINA CITY</div>	PROJECT TITLE: <div>PROPOSED TEMPORARY LEARNING SPACE</div>	OWNER: <div>DEPARTMENT OF EDUCATION DepED</div>	COMMENTS: <div>FRONT ELEVATION / MEAN ELEVATION LEFT SIDE ELEVATION / RIGHT SIDE ELEVATION</div>	DATED: 08/20/2024 DRAWN BY: MARICEL C. CELIS CHECKED BY: MARICEL C. CELIS DESIGNED BY: MARICEL C. CELIS
	LOCATION: <div>ADDRESS: BARCELONA, MARIKINA CITY, NCR</div>							

NOTE: THIS DRAWING IS THE PROPERTY OF DEPED. IT IS TO BE USED FOR THE PURPOSES OF THE PROJECT ONLY. IT IS NOT TO BE REPRODUCED OR COPIED IN PART OR IN WHOLE WITHOUT THE WRITTEN PERMISSION OF DEPED.

Annex B - Standard DepEd TLS Design

SCHEDULE OF WOOD COMPONENTS	
COMPONENT	SPECIFICATIONS
POST	100mmx100mm COCO LUMBER
BEAM GIRDER	50mmx75mm COCO LUMBER
RAFTER TOP CHORD	50mmx75mm COCO LUMBER
RAFTER RIDGE BOARD	50mmx100mm COCO LUMBER
RAFTER COLLAR TIE	50mmx75mm COCO LUMBER
PURLINS	50mmx60mm COCO LUMBER
DIAGONAL WALL STUD	50mmx60mm COCO LUMBER

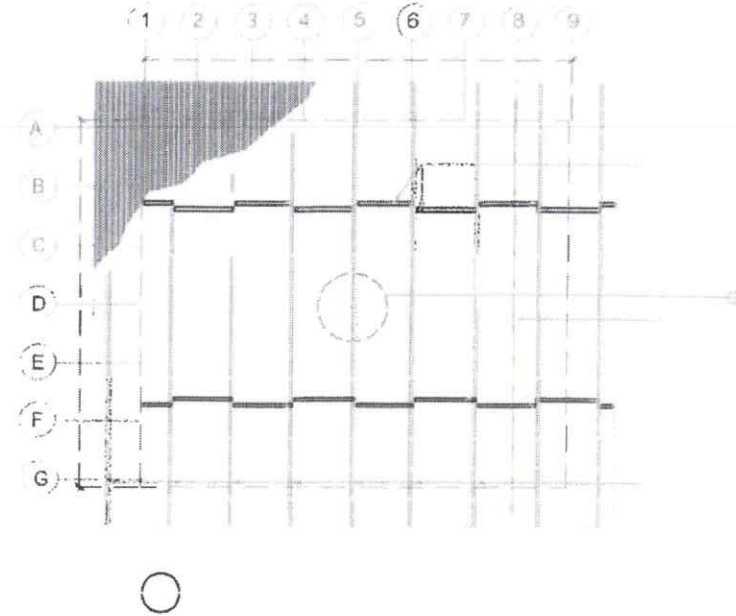
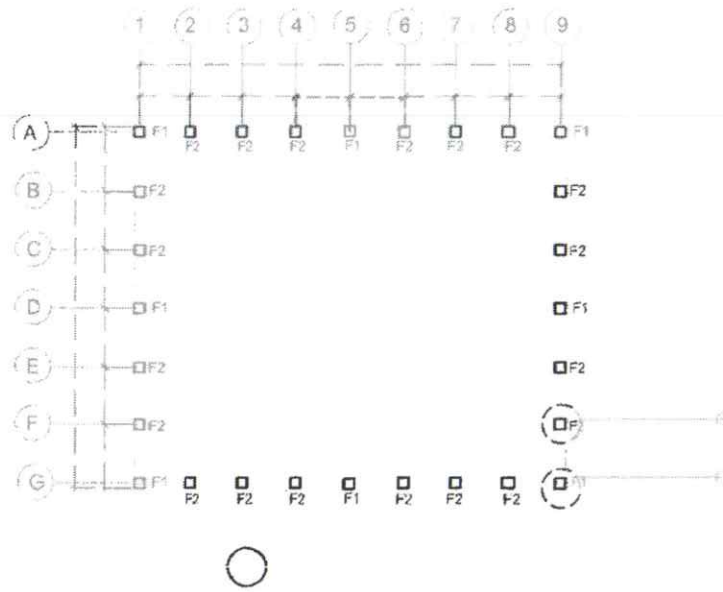

	DESIGNED BY: ARCH. ROBERTO C. CLAS CIVIL ENGINEER, RCE-001 DIVISION OFFICE - MARIKINA CITY	CHECKED BY: ENGR. ROBERTO C. CLAS CIVIL ENGINEER, RCE-001 DIVISION OFFICE - MARIKINA CITY	REVIEWED BY: ENGR. ROBERTO C. CLAS CIVIL ENGINEER, RCE-001 DIVISION OFFICE - MARIKINA CITY	APPROVED BY: ENGR. ROBERTO C. CLAS CIVIL ENGINEER, RCE-001 DIVISION OFFICE - MARIKINA CITY	PROJECT TITLE: PROPOSED TEMPORARY LEARNING SPACE	OWNER: DEPARTMENT OF EDUCATION DepEd	DATE: 2023-08-20
	FOUNDATION PLAN ROOF-FRAMING PLAN					PROJECT NO.: 2023-08-20	

THIS DRAWING IS AN INSTRUMENT OF SERVICE AND THE PROPERTY OF MARICOPA PROJECTS AND DESIGN. IT IS TO BE USED ONLY FOR THE PROJECT AND SITE SPECIFIC. ALL INFORMATION IS TO BE SECURED AND NOT TO BE REPRODUCED OR COPIED IN ANY FORM OR BY ANY MEANS WITHOUT THE WRITTEN PERMISSION OF MARICOPA PROJECTS AND DESIGN.

Annex B - Standard DepEd TLS Design

SCHEDULE OF WOOD COMPONENTS	
COMPONENT	SPECIFICATIONS
POST	100mmx100mm COGO LUMBER
BEAM GIRDER	50mmx75mm COGO LUMBER
RAFTER TOP CHORD	50mmx75mm COGO LUMBER
RAFTER RIDGE BOARD	50mmx100mm COGO LUMBER
RAFTER COLLAR TIE	50mmx75mm COGO LUMBER
PURLINS	50mmx50mm COGO LUMBER
DIAGONAL WALL STUD	50mmx50mm COGO LUMBER

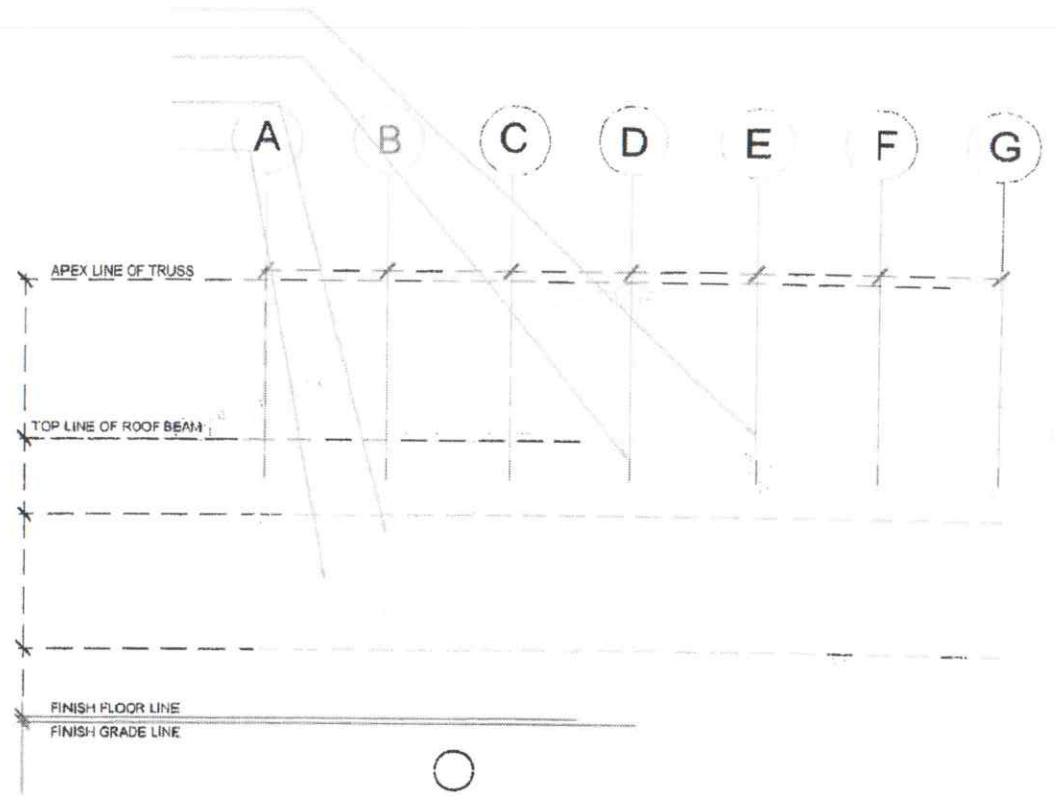
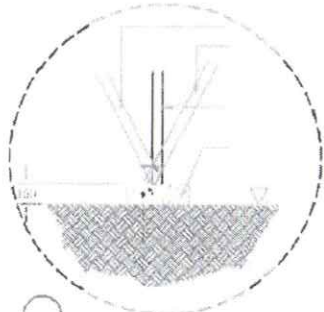
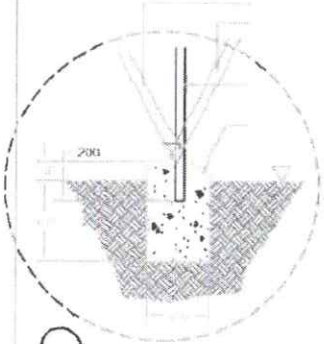
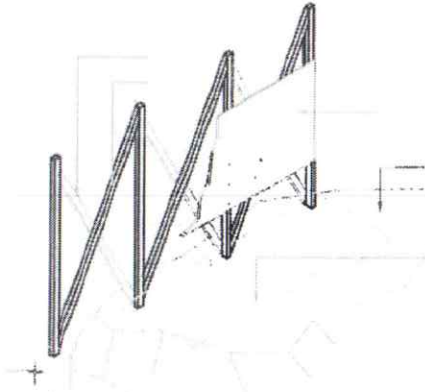
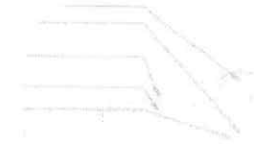
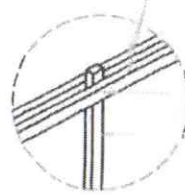
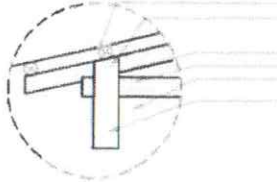

	DESIGNED BY: APPROVED BY: DATE:	CHECKED BY: APPROVED BY: DATE:	REVISIONS: APPROVED BY: DATE:	APPROVED BY: DATE:	PROJECT TITLE: PROPOSED TEMPORARY LEARNING SPACE	CLIENT: DEPARTMENT OF EDUCATION DepEd	LOCATION: BRANCO ALBINO, PANG. CITY, BUL.	SHEET NO. 1 OF 1 DATE: 08/20/2019
--	---------------------------------------	--------------------------------------	-------------------------------------	-----------------------	--	---	--	--------------------------------------

THIS DRAWING IS AN INSTRUMENT OF SERVICE. IT IS THE PROPERTY OF THE CLIENT. IT IS TO BE USED ONLY FOR THE PROJECT AND SITE SPECIFIC. ALL INFORMATION IS TO BE RETURNED TO THE CLIENT UPON REQUEST.

Annex B - Standard DepEd TLS Design

SCHEDULE OF WOOD COMPONENTS	
COMPONENT	SPECIFICATIONS
POST	100mmx100mm COCO LUMBER
BEAM GIRDER	50mmx75mm COCO LUMBER
RAFTER TOP CHORD	50mmx75mm COCO LUMBER
RAFTER RIDGE BOARD	50mmx100mm COCO LUMBER
RAFTER COLLAR TIE	50mmx75mm COCO LUMBER
PURLINS	50mmx50mm COCO LUMBER
DIAGONAL WALL STUD	50mmx50mm COCO LUMBER

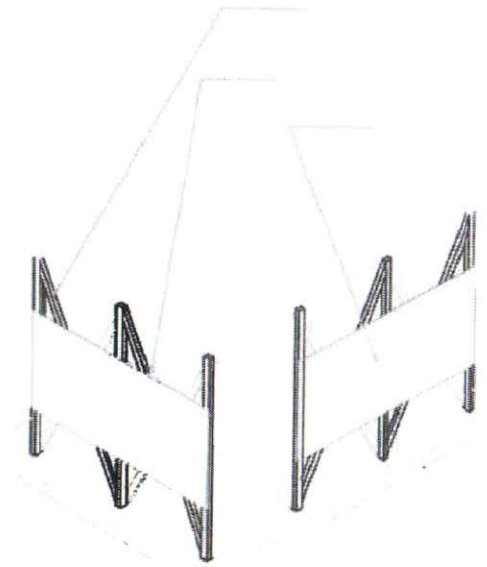
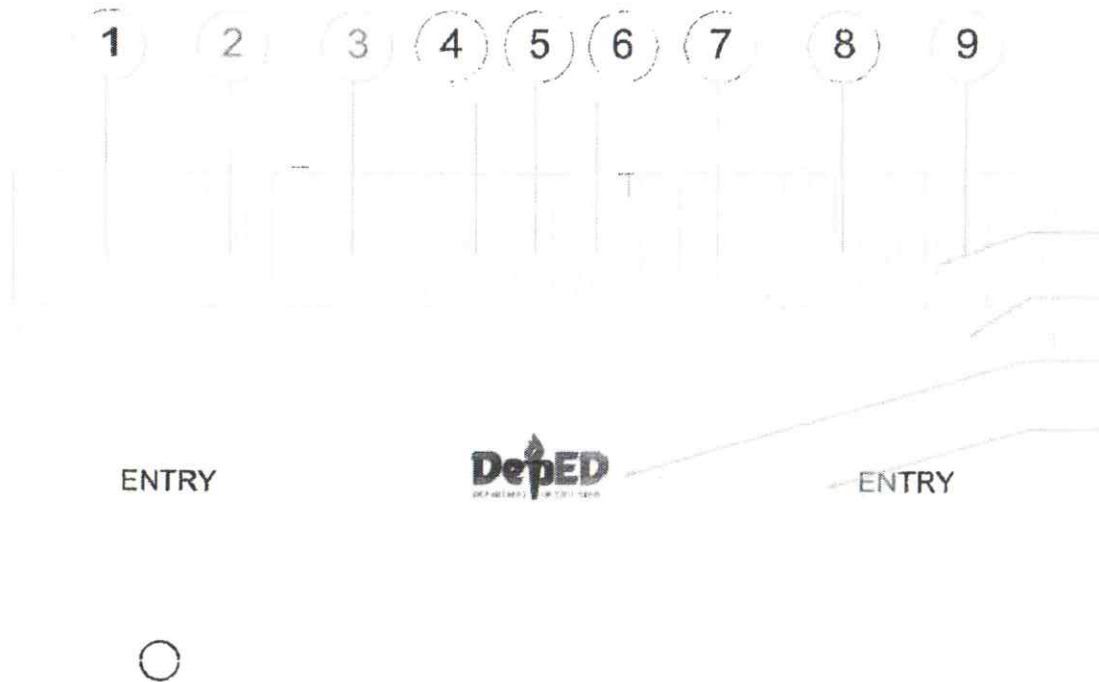
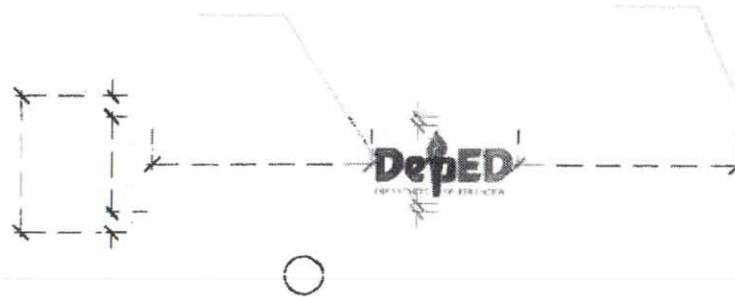

	DESIGNED BY: NAME: JOSEPH C. DELA CRUZ DESIGNER: JOSEPH C. DELA CRUZ PROJECT: PROPOSED TEMPORARY LEARNING SPACE	CHECKED BY: NAME: JOSEPH C. DELA CRUZ CHECKER: JOSEPH C. DELA CRUZ PROJECT: PROPOSED TEMPORARY LEARNING SPACE	APPROVED BY: NAME: JOSEPH C. DELA CRUZ APPROVER: JOSEPH C. DELA CRUZ PROJECT: PROPOSED TEMPORARY LEARNING SPACE	PROJECT TITLE: PROPOSED TEMPORARY LEARNING SPACE	OWNER: DEPARTMENT OF EDUCATION DepEd	DRAWING: DETAIL OF LONG AND SHORT WORK DETAIL OF LONG OR SHORT ELEVATION ISOMETRIC DETAIL OF LONG COLOR SCHEME	SHEET NO. 1 OF 1 DRAWN BY: JOSEPH C. DELA CRUZ CHECKED BY: JOSEPH C. DELA CRUZ DESIGNED BY: JOSEPH C. DELA CRUZ DATE: 2023-08-01
	PROJECT NO.: 1 LOCATION: 1	PROJECT NO.: 1 LOCATION: 1	PROJECT NO.: 1 LOCATION: 1	PROJECT NO.: 1 LOCATION: 1	PROJECT NO.: 1 LOCATION: 1	PROJECT NO.: 1 LOCATION: 1	PROJECT NO.: 1 LOCATION: 1

NOTES: 1. ALL DIMENSIONS ARE IN METERS. 2. ALL DIMENSIONS ARE IN METERS. 3. ALL DIMENSIONS ARE IN METERS. 4. ALL DIMENSIONS ARE IN METERS. 5. ALL DIMENSIONS ARE IN METERS. 6. ALL DIMENSIONS ARE IN METERS. 7. ALL DIMENSIONS ARE IN METERS. 8. ALL DIMENSIONS ARE IN METERS. 9. ALL DIMENSIONS ARE IN METERS. 10. ALL DIMENSIONS ARE IN METERS.

Instructions: The total approved TLS units is fixed and should be equivalent to total TLS units implemented by the division. If there are calls not applicable, kindly indicate "N/A". The first, second, and third update on TLS Monitoring should be submitted on the second, fourth, and sixth week after receipt of approved TLS allocation, respectively. The first submission should include complete information on "A) Implementation Plan" while the second and third submission should include information on the rest of the columns below. The last submission on the sixth week after receipt of approved TLS allocation should include other pertinent documents and photos indicated in the guidelines. If there are concerns regarding the implementation of TLS, kindly contact DepEd DRRMS immediately (drrms@deped.gov.ph; tel no. 02-636 4367).

Total amount released to the division: PHP _____ Sub-ARO number: _____ Date: _____
Total amount released to the division: PHP _____ Sub-ARO number: _____ Date: _____

Approved by:

Date accomplished

Schools Division Superintendent

PLEASE DO NOT PRINT THIS PAGE

(A) Implementation plan - The implementation plan involves the planning and setting of timelines for procurement and construction of temporary learning spaces (TLS)

Target completion date procurement - The target date of completion of procurement is the desired date when divisions are able to procure materials and labor for construction of TLS.

Target completion date of construction - The target date of completion of TLS construction is the desired date when divisions are able to complete the construction of TLS for temporary use of learners of a recipient school

Actual completion date of pre-procurement: The actual completion date of pre-procurement activities. Pre-procurement activities may be one of the following: request for release of NCA from the DBM, preparation of bid documents, canvassing of materials, transmittal of memorandum to recipient schools, among others, depending on the mode of procurement to be used by the division.

Actual completion date of procurement - The actual completion date of procurement activities. Procurement usually follow after pre-procurement has been completed. The start of procurement may be triggered by one of the following: direct negotiation of contract with supplier, posting of advertisement, among others, depending on the mode of procurement to be used by the division.

Total actual TLS units procured - The number of TLS units which are procured and obligated for construction.

of construction of TLS - Construction of temporary learning spaces (TLS) includes mobilization and actual TLS

Total actual TLS units ongoing mobilization - The number of TLS units which are ongoing mobilization. Mobilization activities include delivery of materials and site/ground preparation leading to TLS construction.

Total actual TLS units ongoing construction - The number of TLS units which are ongoing construction. Construction activities include roofing and carpentry works, among others.

Total actual TLS units completed - The actual number of TLS units completed for temporary use of learners of a recipient school.

Actual completion date of construction - The actual completion date of TLS construction for temporary use of learners of a recipient

Financial status of TLS - Financial status of TLS includes total financial obligations and disbursements related to TLS construction. The financial status

Contract number, project name, and location are for information only. The contract and, depending on the contract and mode of procurement used by the division, the contract number, project name, and location are not necessarily the same as those used by the contractor.

(E) Remarks - Challenges and issues, reasons for delays, and other concerns not captured in the template should be indicated in the remarks column.

**PROGRAM OF WORKS
DETAILED COST ESTIMATES**

PROJECT: PROPOSED ONE (1) CLASSROOM TEMPORARY LEARNING SPACE

Item No.	Description	UNIT	QTY.	UNIT COST	TOTAL COST	GRAND TOTAL
MATERIALS						
A	Earthworks					
	Crushed Gravel 3/4	cu.m.	5.00	P 700.00	P 3,500.00	
	Sub-total				P 3,500.00	P 3,500.00
B	Concreting Works					
	Portland Cement	bags	50.00	P 252.00	P 12,600.00	
	Sand	cu.m.	4.00	P 980.00	P 3,920.00	
	Crushed Gravel 3/4	cu.m.	6.00	P 1,405.00	P 8,430.00	
	Sub-total				P 24,950.00	P 24,950.00
C	Rebar Works					
	D10mm x 6.00 mts RSB	pc	25.00	P 171.12	P 4,278.00	
	G.I. Wire #16	kg	6.00	P 71.40	P 428.40	
	Sub-total				P 4,706.40	P 4,706.40
D	Roofing Works					
	Pre-painted Corrugated G.I. Sheet Ga.26 36"x8'	pc	44.00	P 1,450.00	P 63,800.00	
	Pre-painted Ridge Roll Ga.26 24"x8'	pc	4.00	P 303.33	P 1,213.33	
	Umbrella Nails	kg	7.00	P 79.00	P 553.00	
	Roof Sealant	L	1.00	P 470.00	P 470.00	
	Roof Insulator 10mm x 1m	l.m.	80.00	P 90.00	P 7,200.00	
	Sub-total				P 73,236.33	P 73,236.33
E	Carpentry Works					
	<i>Front, Rear, Right & Left Elevations</i>					
	2"x3" Coco Lumber, Wood Beam	bd.ft.	180.00	P 35.00	P 6,300.00	
	4"x4" Coco Lumber, Main Post	bd.ft.	150.00	P 35.00	P 5,250.00	
	2"x3" Coco Lumber, Secondary Post	bd.ft.	140.00	P 35.00	P 4,900.00	
	2"x3" Coco Lumber, Diagonal Wall Stud	bd.ft.	215.00	P 35.00	P 7,525.00	
	Plywood Marine 1/4"x4"x8'	pcs	18.00	P 378.00	P 6,804.00	
	Common Wire Nails	kg	15.00	P 80.00	P 1,200.00	
	Machine Bolts with Std. Nuts and Washers, 1/2"x7"	pcs	90.00	P 15.00	P 1,350.00	
	<i>Blackboard and walls</i>					
	Rough Lumber, Sun-Dried, Tanguile	bd.ft.	40.00	P 43.00	P 1,720.00	
	Lawanit 1/4" thk	pcs	2.00	P 280.00	P 560.00	
	Finishing Nails	kg	1.00	P 80.00	P 80.00	
	Common Wire Nails	kg	1.00	P 80.00	P 80.00	
	Sub-total				P 35,769.00	P 35,769.00
F	Painting Works					
	Enamel, Flatwall	gal	5.00	P 595.00	P 2,975.00	
	Enamel, Semi-Gloss	gal	3.00	P 620.00	P 1,860.00	
	Paint Thinner	gal	1.00	P 286.00	P 286.00	
	Paint Brush, 2"	pcs	3.00	P 180.00	P 540.00	
	Roller Brush, 4"	pcs	2.00	P 115.00	P 230.00	
	Sub-total				P 5,891.00	P 5,891.00
	Sub-total =				P 148,052.73	P 148,052.73
Item No.	Description	UNIT	QTY.	UNIT COST	TOTAL COST	GRAND TOTAL
LABOR						
A	Earthworks					
	Clearing and Grubbing	sq.m.	60.48	P 20.00	P 1,209.60	
	Structural Excavation	cu.m.	2.00	P 249.50	P 499.00	
	Backfilling and Compaction	cu.m.	-	P -	P -	
	Gravel Bedding	cu.m.	5.00	P 283.15	P 1,415.74	
	Sub-total				P 3,124.34	P 3,124.34
B	Concreting Works					
	Concreting of floor slab and pedestal					
	Portland Cement	bags	50.00	P 75.89	P 3,794.42	
	Sand	cu.m.	4.00	P 348.06	P 1,392.25	
	Crushed Gravel 3/4	cu.m.	6.00	P 613.29	P 3,679.75	
	Sub-total				P 8,866.42	P 8,866.42

C	Rebar Works						
	Installation of reinforcing bars for floor slab	kg	342.59				
	D10mm x 6.00 mts RSB	pc	25.00	₱	55.59	₱	1,389.85
	G.I. Wire #16	kg	6.00	₱	23.22	₱	139.32
	Sub-total					₱	1,529.17
D	Roofing Works					₱	1,529.17
	Installation of roofing sheets						
	Pre-painted Corrugated G.I. Sheet Ga.26 36"x8'	pc	44.00	₱	159.30	₱	7,009.20
	Pre-painted Ridge Roll Ga.26 24"x8'	pc	4.00	₱	45.50	₱	182.00
	Umbrella Nails	kg	7.00	₱	11.94	₱	83.59
	Roof Sealant	L	1.00	₱	65.87	₱	65.87
	Roof Insulator 10mm x 1m	l.m.	80.00	₱	5.00	₱	400.00
	Sub-total					₱	7,740.66
E	Carpentry Works					₱	7,740.66
	Front, Rear, Right & Left Elevations						
	Installation of posts and frames						
	2"x3" Coco Lumber, Wood Beam	bd.ft.	180.00	₱	6.45	₱	1,161.14
	4"x4" Coco Lumber, Main Post	bd.ft.	150.00	₱	6.45	₱	967.62
	2"x3" Coco Lumber, Secondary Post	bd.ft.	140.00	₱	6.45	₱	903.11
	2"x3" Coco Lumber, Diagonal Wall Stud	bd.ft.	215.00	₱	6.45	₱	1,386.92
	Plywood Marine 1/4"x4"x8'	pcs	18.00	₱	149.57	₱	2,692.32
	Common Wire Nails	kg	15.00	₱	15.71	₱	235.64
	Machine Bolts with Std. Nuts and Washers, 1/2"x7"	pcs	90.00	₱	4.80	₱	432.00
	Blackboard and walls						
	Fabrication and Installation of blackboard and walls	sq.m.					
	Rough Lumber, Sun-Dried, Tanguile	bd.ft.	40.00	₱	17.34	₱	693.74
	Lawanit 1/4" thk	pcs	2.00	₱	84.62	₱	169.25
	Finishing Nails	kg	1.00	₱	23.48	₱	23.48
	Common Wire Nails	kg	1.00	₱	15.71	₱	15.71
	Sub-total					₱	8,680.93
F	Painting Works					₱	8,680.93
	Painting of posts, walls, and blackboard						
	Enamel, Flatwall	gal	5.00	₱	156.32	₱	781.59
	Enamel, Semi-Gloss	gal	3.00	₱	150.55	₱	451.66
	Paint Thinner	gal	1.00	₱	72.53	₱	72.53
	Paint Brush, 2"	pcs	3.00	₱	100.00	₱	300.00
	Roller Brush, 4"	pcs	2.00	₱	200.00	₱	400.00
	Sub-total					₱	2,005.78
						₱	2,005.78
						₱	31,947.30
	DIRECT COST						
	I. Materials Cost						148,052.70
	II. Labor Services Cost						31,947.30
	TOTAL CONSTRUCTION COST					₱	180,000.00
	TOTAL PROJECT COST					₱	180,000.00

Prepared by:

ENGR. REINA LEIGH C. CRUCILLO, CE
 Senior Technical Assistant II

Recommending Approval:

RONILDA R. CO
 Director IV, DRRMS

Noted by:

ENGR. ANNABELLE E. PANGAN
 Chief, Education Facilities Division

Approved by:

ATTY. MICHEL KRISTIAN R. ABLAN, CESO I
 Undersecretary for Administration and Procurement

Annex A. List of recipient schools to receive the support fund for the Construction of TLS in Schools Affected by Typhoon ODETTE”

#	SCHOOL ID	SCHOOL	DISTRICT	# of TLS
1	118063	Bato ES	Buenavista 2	1
2	118081	Nueva Montaña ES	Buenavista 2	2
3	312312	Panghagban HS	Buenavista 2	3
4	118239	Danao CES	Danao	1
5	118249	Sta. Ana ES	Danao	2
6	312326	Cuaming HS	Inabanga North	3
7	302882	Pangangan NHS	Calape	3
8	103611	Cantumogcad ES	Buenavista 2	1
9	186513	Lapu-lapu ES	Carmen 1	2
10	118721	Magsaysay ES	Talibon 1	2
11	118735	Calituban ES	Talibon 2	3
12	300519	Mahanay HS	Talibon 2	3
13	118774	Bilang-bilangan ES	Tubigon East	1
14	118773	Batasan ES	Tubigon East	2
15	118809	Cagting ES	Ubay 2	3
16	500214	Tapal IS	Ubay 1	3
17	118843	Ubay CES	Ubay 1	3
18	312351	Cagting HS	Ubay 2	3
19	118839	Tipolo ES	Ubay 2	3
20	118832	San Pascual ES	Ubay 3	3
21	302899	San Pascual National Agr'l HS	Ubay 3	3

50



0050 Lino Chatto Drive Barangay Cogon, Tagbilaran City, Bohol
 Tel Nos.: (038) 412-4938; (038) 411-2544 (038) 501-7550
 Telefax: (038) 501-7550 email add: deped.bohol@deped.gov.ph

